

MTX[®]

AUDIO

mtx.com - mixaudio.eu



iT1 air

Ultimate Apple[®] AirPlay[®] Lightning[®] Hifi
Powerful Compact System with Exceptional Bass Extension.





● Thank You !

Thank you for purchasing the MTX iT1air high-end, high-definition audio system. The iT1air is designed to deliver a deeper dimension that brings your music to life. No other system provides the exacting measure of clarity in such a small enclosure. Whether you are listening from your iPad, iPhone, iPod or computer, the iT1air delivers outstanding sound quality. The iT1air is your new favorite Hi-Fi system. Congratulations for making a smart choice and enjoy the ultimate audio experience with MTX.

● What's In the Box ?

1. The iT1air unit. Use caution when unpacking as the unit is heavy.
2. IR remote control. Batteries are not included.
3. Wi-Fi antenna to be connected to the Wi-Fi socket on the back of the unit.
4. Two power cords. One for the European plug (CEE 7/16 Type C and one for the United Kingdom plug (BS 1363 Type G).
5. The owner's manual.

● Quick Start with Airplay :

1. Connect the iT1air to the wall outlet. Switch on the unit - press "Power" (⏻) once - and wait 10 seconds for initialization.
2. Verify your iPhone, iPad or iPod Touch is connected to the Wi-Fi network you want to join.
3. Connect your device to the Dock (LED#2 red) or to the USB (LED#2 green).
4. Push the Wi-Fi control (📶) once. The unit will display a message on your iDevice asking if you want to share your Wi-Fi settings with the iT1air. Accept. The iT1air is now available in the Wi-Fi network. The LED#1 should be solid Blue. You can now disconnect your device from the iT1air.
5. Use your computer or iDevice and open "iTunes" or "Music". In the Airplay devices list, choose "MTX iT1air" and hit play to start listening to music.

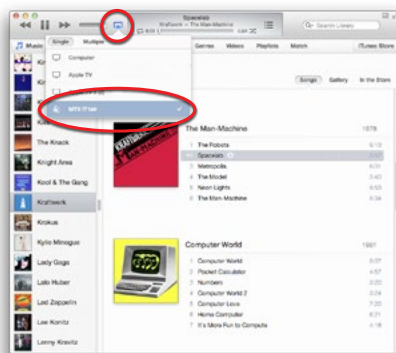

● LED Status Summary :



Left - LED#1 :

- Flashing Blue: Looking for the Wi-Fi network
- Solid Blue: Hooked to the Wi-Fi network
- Flashing Red: Remote control feedback
- Flashing Blue/Purple: Wi-Fi setting mode

Right - LED#2 :

- Solid Blue : Airplay input selected
- Solid Red : Dock input selected
- Solid Green : USB input selected
- Solid Purple : AUX input selected

● iT1air Placement and Installation :

The location of your iT1air in the room is crucial for sound quality and bass level. The unit is equipped with two side subwoofers and is able to reproduce very low frequencies. Some guidelines should be followed to get the best possible result.

1. Install the unit at an equal distance between the two side walls to get the largest possible staging. The side walls will act as reflectors.
2. If you reduce the distance between the unit and the back wall, the bass level will rise. If you increase the distance, the bass level will decrease. Choose distance based on your preference.
3. Your ears and the iT1air should be in the same horizontal plane for perfect definition.
4. To get the best possible result, do not put the unit on a table with a large panel in front of the speakers as it will reflect the sound in an undesirable way.
5. Adjust the subwoofer level with the remote control.

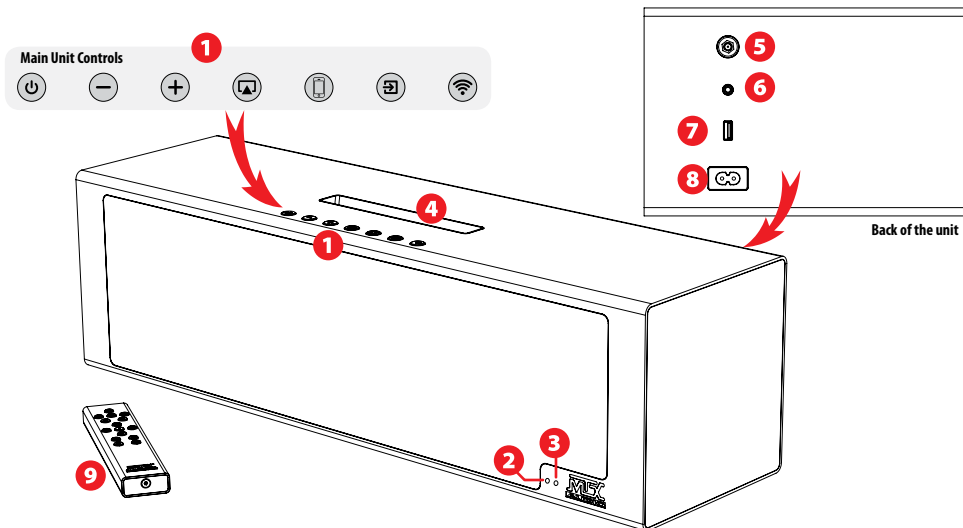

1 Main Unit Controls

**Power On/Off
Reset**



- Single press will power On or power Off the unit. When the unit is Off, the two LEDs will not be illuminated. When the Unit is On, the two LEDs will be illuminated. LED color will depend on the input and settings.
- Press and hold for 5 seconds to reset the unit's sound settings (volume and subwoofer level to zero).

Volume Down



- Single press will decrease the volume one step - The LED#1 will flash red once.
- Press and hold will decrease volume gradually - The LED#1 will flash red continuously.

Volume Up



- Single press will increase the volume one step - The LED#1 will flash red once.
- Press and hold will increase the volume gradually - The LED#1 will flash red continuously.

**Source : AirPlay
Direct mode**



- Single press will enable Airplay mode - The LED#2 will turn Blue.
- Press and hold for 5 seconds will enable the Wi-Fi direct mode, the unit will turn into a router and you'll be able to stream from your Airplay device directly to the unit without any external network.

**Source Select :
Dock - USB**



- First single press will enable dock input - The LED#2 will turn Red
- Second single press will enable USB input - The LED#2 will turn Green

**Source Select :
Analogue Jack**



- Single press will enable the jack input - The LED#2 will turn Purple.

**Wi-Fi Connection
Settings Mode**



- Single press will copy the Wi-Fi settings of your wired device to the unit. The unit will be available on the same network as your device.
- Press and hold for 5 seconds will turn the unit to Wi-Fi settings mode - The LED#1 will flash Blue/Purple. See section «How To : Connect to the network for Airplay #2» for more details.

2 LED#1 : Wi-fi Status and Remote Feedback.

When you switch on the unit, the LED#1 will slowly flash blue looking for the Wi-Fi network. It will continue to flash Blue until the network is set. When the unit is connected to your network, the LED#1 will turn to solid Blue. When you press any control on the IR remote control, the LED#1 will flash red/blue to indicate that the connection is done.

3 LED#2 : Input Indicator.

- Press for Airplay input - The LED#2 turns blue.
- Press for Dock input - The LED#2 will turn red.
- Press again for USB input - The LED#2 will turn green.
- Press for Jack Aux Analogue input - The LED#2 will turn purple.



4 Lightning Dock & Compatible Devices

Put one of the following devices in the Lightning dock. Press  till the LED#2 turns to red. Launch Music and push play. Enjoy the tunes stored on your device.



The Apple devices not listed here are still compatible. But they'll have to use the USB input (see **7**)

5 Wifi Antenna Connector.

Screw the included wifi antenna here for optimal Airplay® performances.

6 AUX Analog 3,5mm Jack Input.

Use this input with stereo analog signals from a TV, a Blue Ray/DVD/CD player, an MP3 player, a Tablet, a cellular phone, etc. Do not forget to press "AUX input"  to activate the AUX Analog jack input. The LED will turn purple.

7 Apple® USB Input.

Do not forget to press  once or twice to activate the USB input. The LED will turn green.

USB works with iPhone 5, iPhone 5C, iPhone 5S, iPhone 4S, iPhone 4, iPhone 3GS, iPhone 3G, iPhone, iPad air, iPad (3rd and 4th generation), iPad 2, iPad, iPad mini, iPod touch (1st through 5th generation), iPod classic, and iPod nano (1st through 7th generation).

8 AC Power Socket.

Connect your iT1air to the power supply. Use the included power cord.

The unit is compatible with 100~120V / 220~240V AC, 50~60Hz. You don't need to move any switch, the selection is automatic.

9 IR Remote Control.

Before using the remote control, you must install two AAA batteries. Remove the bottom panel with a 2mm HEX key. Follow the (+) and (-) signs located around the two springs. See "How To : Install the Batteries in the Remote Control" on the next page.

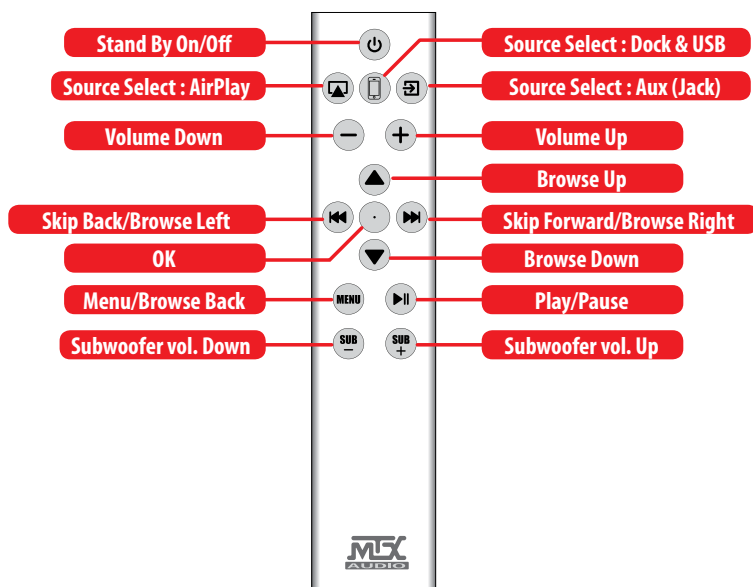



9 IR Remote Control Behavior.

Power On/Off Reset		<ul style="list-style-type: none"> • A single push will power On or power Off the iT1air. When the unit is Off, the two LEDs will be Off. When the Unit is On, the two LEDs are on. LEDs colors depend on the input and wifi settings.
Source : AirPlay Direct mode		<ul style="list-style-type: none"> • A single push will enable Airplay Input - The LED#2 will turn to solid Blue. • Press and hold for 5 seconds will enable the Direct Wi-Fi mode and you'll be able to stream from your computer, from iTunes or from your Airplay device directly to the unit without any external network. The iT1air will create the network.
Source : Dock - USB		<ul style="list-style-type: none"> • First push will enable Dock input - The LED#2 will turn to solid Red. • Second push will enable USB input - The LED#2 will turn to solid Green.
Source Select : Aux (Jack)		<ul style="list-style-type: none"> • Single push will enable the Aux Analogue 3,5mm jack input - The LED#2 will turn to solid Purple.
Volume Up		<ul style="list-style-type: none"> • Single push will increase the volume one step - The LED#1 will flash red twice. • Press and hold will increase the volume gradually - The LED#1 will flash red continuously.
Volume Down		<ul style="list-style-type: none"> • Single push will decrease the volume one step - The LED#1 will flash red twice. • Press and hold will decrease volume gradually - The LED#1 will flash red continuously.
Browse UP		<ul style="list-style-type: none"> • Airplay, Dock & USB : Single press will navigate to the top - The LED#1 will flash red twice.
OK		<ul style="list-style-type: none"> • Airplay, Dock & USB : OK/validation - The LED#1 will flash red twice.
Browse Down		<ul style="list-style-type: none"> • Airplay, Dock & USB : Single push will navigate to the bottom. The LED#1 will flash red twice.
Skip Backward Browse Left		<ul style="list-style-type: none"> • Single push : Skips to the next track on the iDevice or in iTunes - the LED#1 will flash red twice. • Press & hold : Fast backward in the current track - the LED#1 will flash red continuously. • AirPlay, Dock & USB : Browse the iDevice : move to the left - the LED#1 will flash red twice.
Skip Forward Browse Right		<ul style="list-style-type: none"> • Single push : Skips to the next track in the iDevice or in iTunes - the LED#1 will flash red twice. • Press & hold : Fast forward in the current track - the LED#1 will flash red continuously. • AirPlay, Dock & USB : Browse the iDevice : move to the right - the LED#1 will flash red twice.
Play / Pause		<ul style="list-style-type: none"> • AirPlay, Dock & USB : Play/Pause - The LED#1 will flash red twice.
Browse Back / Menu		<ul style="list-style-type: none"> • AirPlay & USB -> Browse back the iDevice. It is the same behavior as Apple's «Menu» - the LED#1 will flash red twice.
Subwoofer Volume Up		<ul style="list-style-type: none"> • Single push : increase the subwoofer volume one step - the LED#1 will flash once. • Press and hold increase the subwoofer volume gradually - the LED#1 will flash fast.
Subwoofer Volume Down		<ul style="list-style-type: none"> • Single push : Decrease the subwoofer volume one step - the LED#1 will flash red once. • Press and hold decrease the subwoofer volume gradually - the LED#1 will flash red fast.



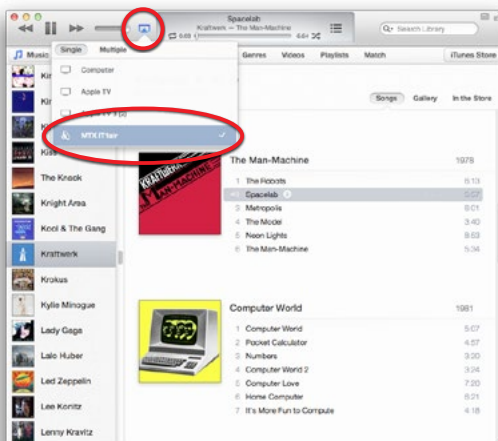

● How To : Connect to the network for Airplay #1 : 5 sec...

1. Connect the iT1air to the wall outlet. Push "Power"  to switch on the unit and wait 10 seconds for initialization.
2. Take your iPhone, iPad or iPod Touch and verify it is connected to the Wi-Fi network.
3. Connect your device to the Dock (LED#2 red) or to the USB (LED#2 green).
4. Push  once. The unit will display a message on your iDevice asking if you want to share your Wi-Fi settings with the iT1air. Accept. The iT1air is now available in the Wi-Fi network. The LED#1 will illuminate solid Blue. You can disconnect your device now.
5. Open a computer or your iDevice and in the Airplay devices list, choose "MTX iT1air".



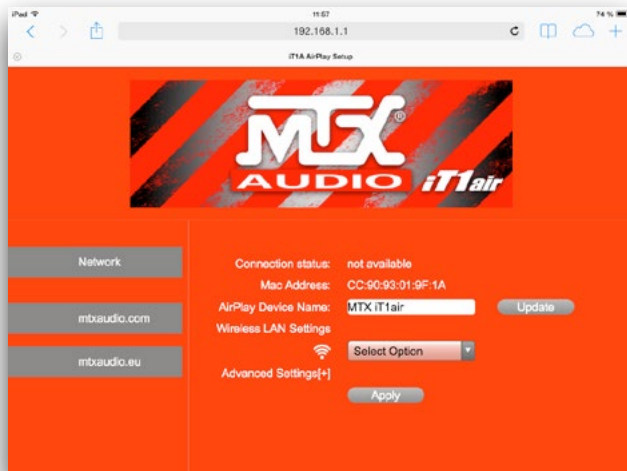

● How To : Connect to the network for Airplay #2 : Geek...

1. Connect the iT1air to the wall outlet. Push  to switch on the unit and wait 10 seconds for initialization.
 2. Press and hold  (Wifi control) for 5 seconds. The LED#1 will flash Blue/Purple.
 3. Take your computer, your iPad, your iPod touch or any Android tablet and look for the iT1 wifi network.
 4. Join the network named "MTX iT1air".
 5. Open a web browser and type **192.168.1.1** - You are now on the iT1air setting page (see picture below).
 6. Choose your network in the list and type your password.
- Note : at the bottom of the Wifi networks list, you can configure it manually, if the network is hidden for example.
7. Hit "Apply". The unit will restart and join the chosen network.
 8. Open a computer or your iDevice. In the Airplay devices list, choose the "MTX iT1air". Hit play... Music...



● How To : Change “MTX iT1air” in the Airplay list.

You can change the unit wifi name if, for example, you have more than one iT1air in the same network.

1. Connect the iT1air to the wall outlet. Push “Power”  to switch on the unit and wait 10 seconds for initialization.
2. Press and hold “Wi-Fi”  for 5 seconds. The LED#1 will flash Blue/Purple.
3. Take your computer, iPad, iPhone, iPod Touch or any Android tablet and look for the iT1 Wi-Fi network.
4. Join “MTX-iT1air-network”.
5. Open a web browser and type 192.168.1.1 - You are now on the iT1air setting page.
6. Type the new desired name in the “AirPlay Device Name field.
7. Hit “Update”. The unit will restart. It will be available in the Airplay devices list under the updated name.



Press and hold
for 5 seconds.

● How To : Reset the unit.

You can reset the volume and the subwoofer settings.

Press and hold for 5 seconds “Power”  on the unit or on the remote control.

● How To : Reset the subwoofer level.

The subwoofer level is adjustable from -5dB to +10dB by 1dB steps.

If you want to go back to 0dB, just push (Sub-) and (Sub+) at the same time on the remote control.

Do not abuse the level of the subwoofers. Too much bass will affect sound quality and add distortion.

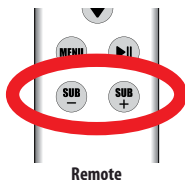

Remote

● How To : Switch on the Wifi Direct mode.

If no Wifi network is available, the iT1air can generate his own wifi network for Airplay.

Press and hold for 5 seconds the Airplay control (on the Unit or on the Remote) will enable the Wifi Direct mode.

The name of the network (SSID) is « MTX iT1air ». The unit will turn into a router and you'll be able to stream from your Airplay device directly to the unit without any external network.



Press and hold
for 5 seconds.

● How To : Install the Batteries in the Remote Control.

Before using the remote control, you must install two AAA batteries.

Remove the bottom panel with a 2mm HEX key. Follow the (+) and (-) signs located around the two springs.

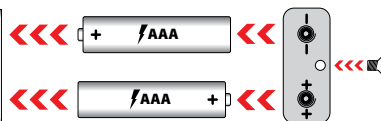
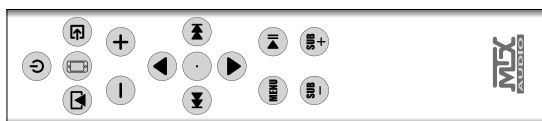

● How To : Stay Tuned.



<https://www.facebook.com/MTXEurope>



<https://twitter.com/MTXEurope>



<http://www.mtxaudio.eu>

MTX is proud to be an American Audio Company since 1971.



MiTek

Corporation

Designed and Engineered by MTX in Phoenix - AZ, USA.

© 2014 Mitek. All rights reserved.

MTX is a registered trademark of Mitek.

Due to continual product development, all specifications are subject to change without notice.

Mitek - MTX

4545 East Baseline Rd. Phoenix, AZ 85042, USA



<https://www.facebook.com/MTXEurope>



<https://twitter.com/MTXEurope>



<http://www.mtxaudio.eu>